

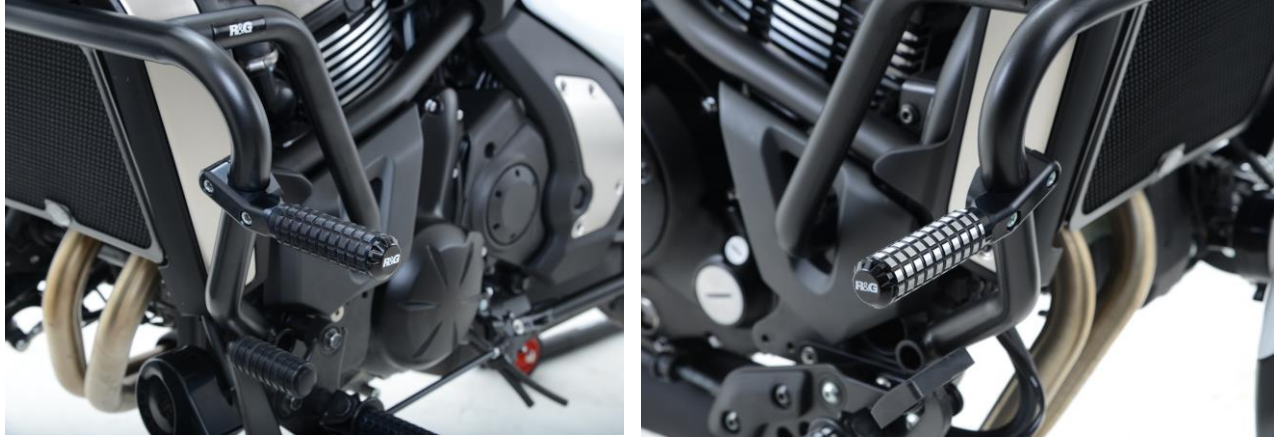

HWP0001

FITTING INSTRUCTIONS FOR HWP0001
HIGHWAY PEGS TO BE FITTED WITH AB0017
KAWASAKI VULCAN S 650 2015-

Page | 1



THIS KIT CONTAINS THE ITEMS PICTURED AND LABELLED BELOW.
DO NOT PROCEED UNTIL YOU ARE SURE ALL PARTS ARE PRESENT.

Please note that the way the kit is packed does not necessarily represent the way of mounting to the bike

THE PARTS SHOWN MAY BE REPRESENTATIVE ONLY (FOR CLARITY OF INSTRUCTIONS ONLY)

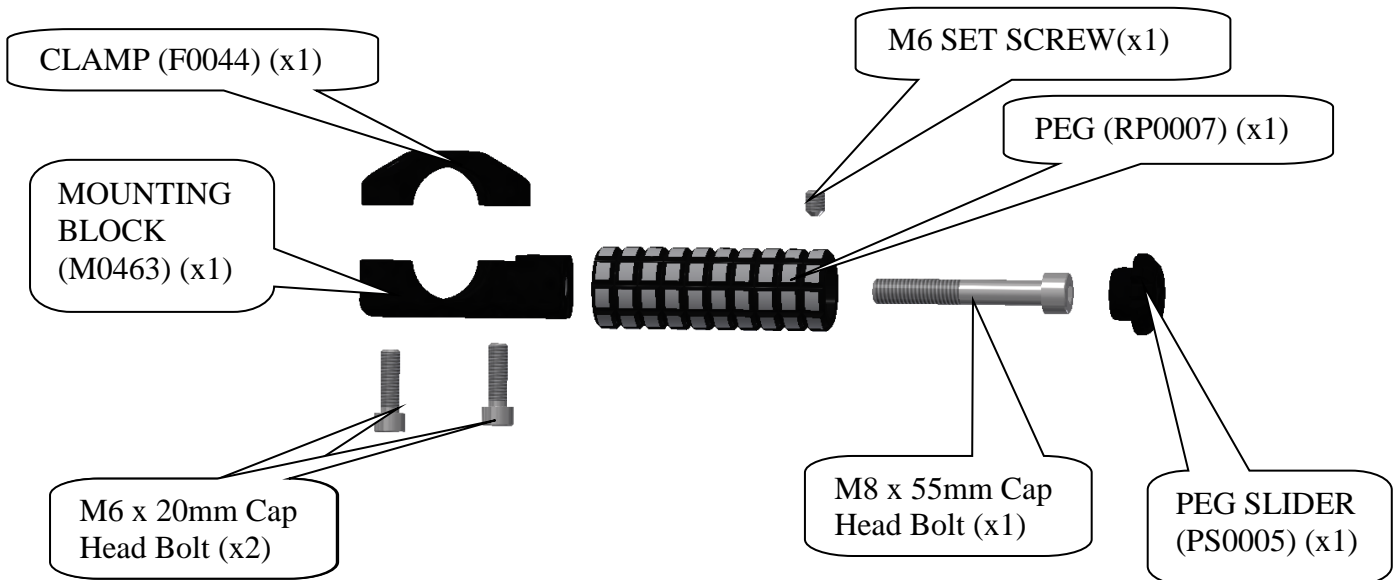

LEFT HAND SIDE



HWP0001

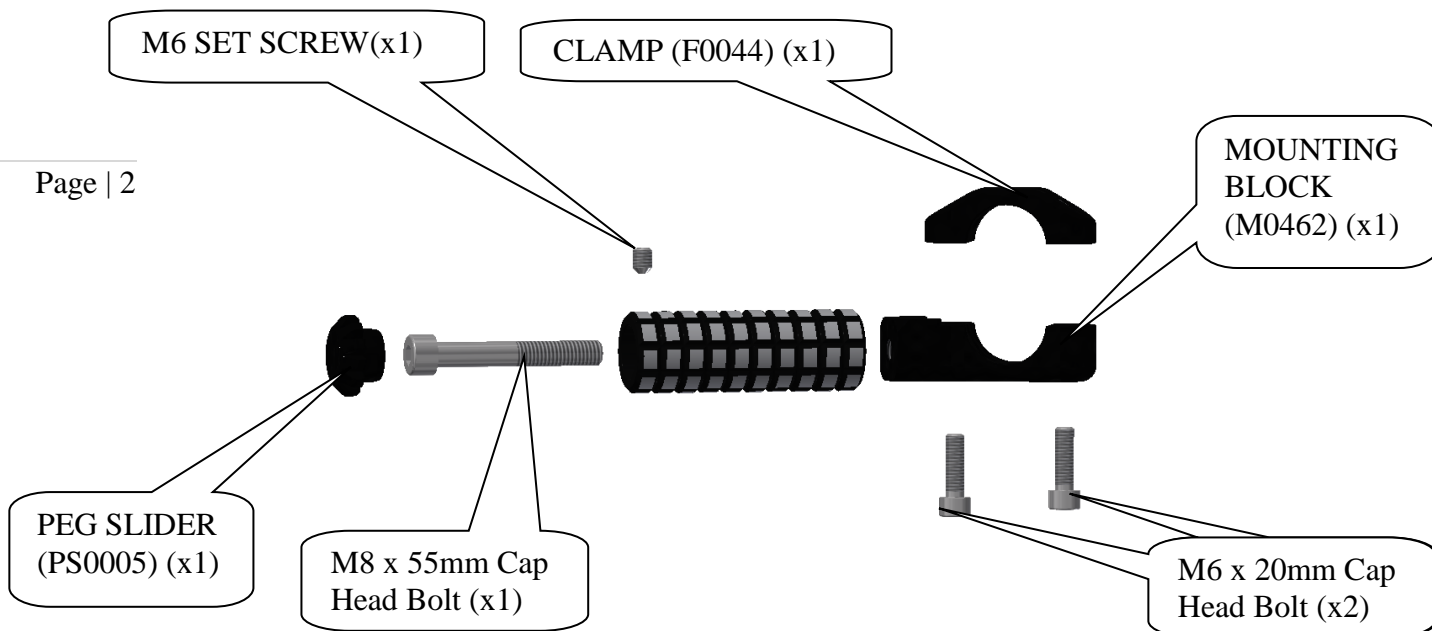

Page | 2

RIGHT HAND SIDE

Please note that in cases where kits are packed with rubber washers holding the components onto the bolt – *the rubber washers should be thrown away!*

TOOLS REQUIRED

- Set of metric Allen keys to include 3, 4 and 5mm A-F.

FITTING INSTRUCTIONS

LEFT HAND SIDE

- Place one of the M8 cap head bolts through one of the pegs so the head of the bolt fits into the counter-bore.
- Engage the exposed thread into the mounting block (M0463) (do not tighten at this stage).
- Place two of the M6 cap head bolts into the mounting block (M0463) so the heads of the bolts fit into the counter-bores in the block.
- Offer this assembly into position as shown in the top left picture ensuring the peg is in a comfortable and usable position.
- Place one of the clamps into position and tighten the two M6 bolts.
- Rotate the peg so the set screw hole is pointing down-wards and tighten the M8 bolt.
- Place the slider into the peg and lock into position using the set screw.
- The assembly may be removed or rotated when not in use.

RIGHT HAND SIDE

- Place the remaining M8 cap head bolt through the remaining pegs so the head of the bolt fits into the counter-bore.

R&G Racing

Unit 1, Shelley's Lane, East Worldham, Alton, Hampshire, GU34 3AQ

Tel: +44 (0)1420 89007 Fax: +44 (0)1420 87301 www.rg-racing.com Email: info@rg-racing.com



HWP0001

Page | 3

- Engage the exposed thread into the mounting block (M0462) (do not tighten at this stage).
- Place the two remaining M6 cap head bolts into the mounting block (M0462) so the heads of the bolts fit into the counter-bores in the block.
- Offer this assembly into position as shown in the top right picture ensuring the peg is in a comfortable and usable position.
- Place the remaining clamps into position and tighten the two M6 bolts.
- Rotate the peg so the set screw hole is pointing down-wards and tighten the M8 bolt.
- Place the slider into the peg and lock into position using the set screw.
- The assembly may be removed or rotated when not in use.

ISSUE 1 22/02/2016 (NSY)

Digital copies of these instructions are available to download from www.rg-racing.com

GENERAL TORQUE SETTINGS

M4 BOLT = 8Nm
M5 BOLT = 12Nm
M6 BOLT = 15Nm
M8 BOLT = 20Nm
M10 BOLT = 40Nm

CONSUMER NOTICE

The catalogue description and any exhibition of samples are only broad indications of the Products and R&G may make design changes which do not diminish their performance or visual appeal and supplying them in such state shall conform to the order. The Buyer acknowledges no representation or warranty (other than as to title) has been given or will apply to the Products other than those in R&G's order or confirmation and the Buyer confirms it has chosen the Products as being of merchantable quality and suitable for its particular purposes. Where R&G fits the Products or undertakes other services it shall exercise reasonable skill and care and rectify any fault free of charge unless the workmanship has been disturbed. The Buyer is responsible for ensuring that the warranty on the motorcycle is not affected by the fitting of the Products. On return of any defective Products R&G shall at its option either supply a replacement or refund the purchase money but shall not be liable if the Products have been modified or used or maintained otherwise than in accordance with R&G's or manufacturer's instructions and good engineering practice or if the defect arises from accident or neglect. Other than identified above and subject to R&G not limiting its liability for causing death and personal injury, it shall not be liable for indirect or consequential loss and otherwise its liability shall be limited to the amounts paid by the Buyer for the Products or the fitting or service concerned. These terms do not affect the Buyer's statutory rights.

R&G RACING RETURNS POLICY (NON-FAULTY GOODS)

Returns must be pre-authorized (if not pre-authorized the return will be rejected). Goods may only be returned direct to us if they were purchased direct from us (customer must prove if necessary). Otherwise to be returned to original vendor. Goods must be in re-sellable condition, in the opinion of R&G Racing. All returns are subject to a 25% restocking and handling fee (25% of the gross value exc. P&P – at the prevailing price at time of purchase). The customer must pay any and all carriage charges. No returns of discontinued products, unless within 14 days of purchase. This policy does not affect your statutory rights and does not refer to faulty goods.

R&G Racing

Unit 1, Shelley's Lane, East Worldham, Alton, Hampshire, GU34 3AQ

Tel: +44 (0)1420 89007 Fax: +44 (0)1420 87301 www.rg-racing.com Email: info@rg-racing.com



HWP0001

NOTICE DE MONTAGE HWP0001
PEGS DE ROUTE (AVEC AB0017)
KAWASAKI VULCAN S 650 2015-

Page | 4

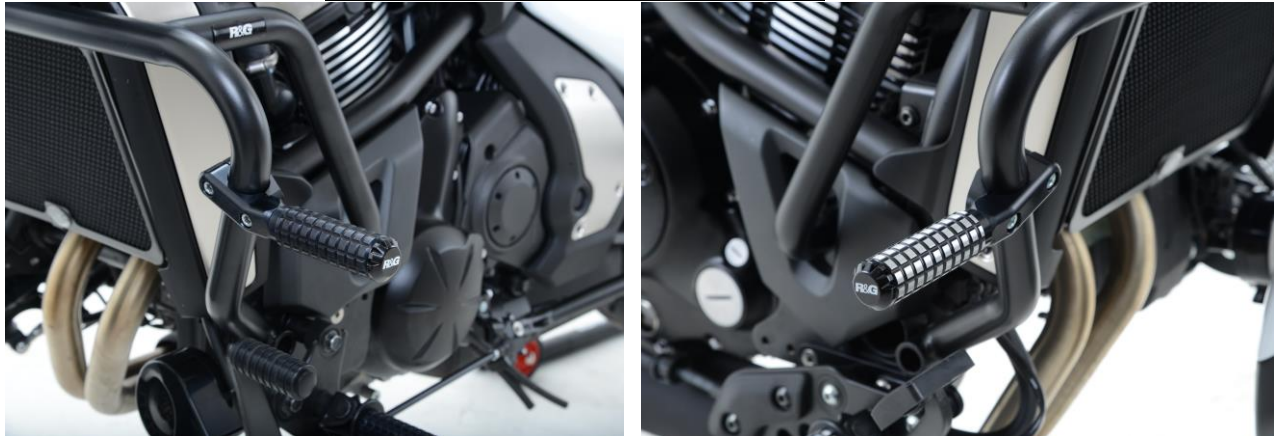

LE KIT CONTIENT LES ARTICLES EXPOSES CI-DESSOUS, VERIFIER QUE TOUTES LES PIECES SOIENT PRESENTES AVANT DE PROCEDER AU MONTAGE.

La façon dont le kit est emballé ne correspond pas forcément à la façon de monter les pièces sur la moto

LES PARTIES PRESENTEES PEUVENT ETRE UNIQUEMENT REPRESENTATIVES
(POUR LA CLARTE DES INSTRUCTIONS UNIQUEMENT)

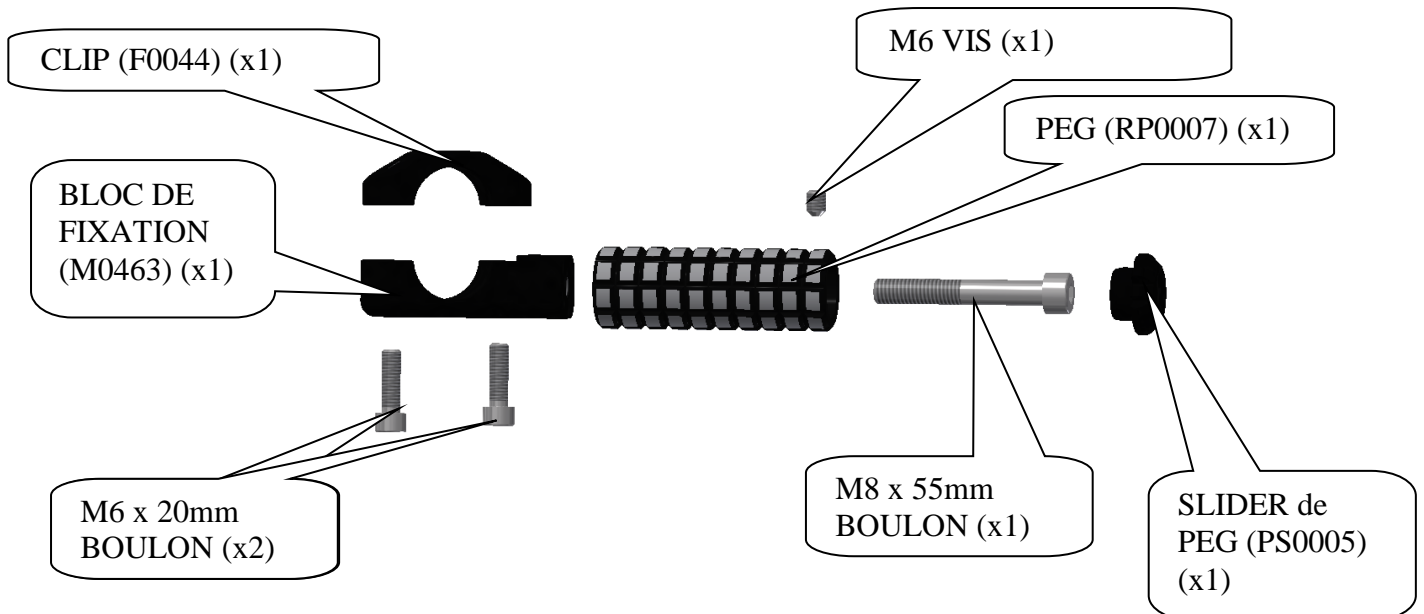

LEFT HAND SIDE



HWP0001

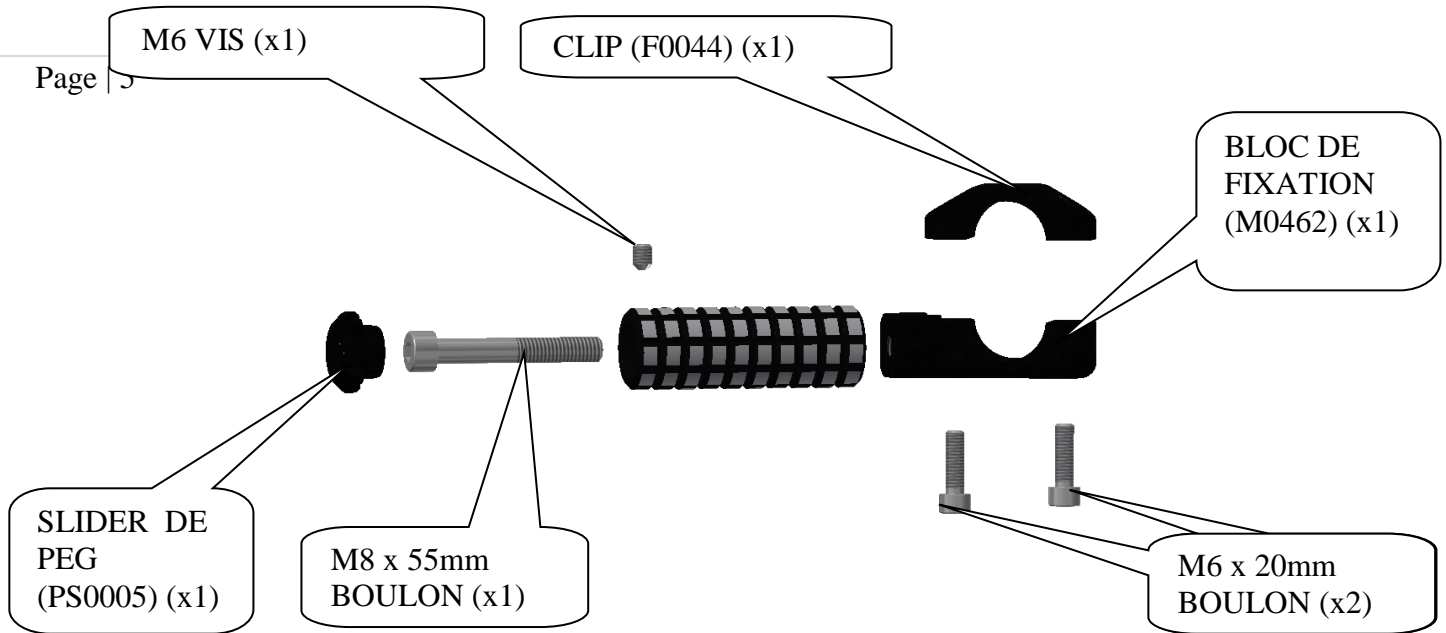

COTE DROIT

Notez que si les kits sont emballés avec des rondelles en caoutchouc servant à tenir les composants, *ces rondelles doivent être jetées!*

OUTILS REQUIS

- Clés Allen 3, 4 et 5mm.

NOTICE DE MONTAGE

COTE GAUCHE

- Placer un des boulons M8 dans un des pegs de façon à ce que la tête du boulon se place dans le contre alésage.
- Engager le filetage dans le bloc de fixation (M0463) (Ne pas serrer pour le moment).
- Placer 2 des boulons M6 dans le bloc de fixation (M0463) de façon à ce que les têtes des boulons se placent dans les contre alésages du bloc.
- Monter l'ensemble en position comme indiqué sur la photo en haut à gauche, en veillant à ce que le peg soit dans une position confortable.
- Placer une des plaque en position et serrer les 2 boulons M6.
- Tournez le peg de façon à ce que le trou pointe vers le bas puis serrer le boulon M8.
- Placer le slider dans le peg puis bloquer la position en utilisant la vis.
- L'ensemble peut être tourné ou enlevé lorsque vous n'en avez pas besoin.

R&G Racing

Unit 1, Shelley's Lane, East Worldham, Alton, Hampshire, GU34 3AQ

Tel: +44 (0)1420 89007 Fax: +44 (0)1420 87301 www.rg-racing.com Email: info@rg-racing.com



HWP0001

COTE DROIT

Page | 6

- Placer le boulon M8 restant dans le peg restant de façon à ce que la tête du boulon se place dans le contre alésage.
- Engager le filetage dans le bloc de fixation (M0462) (Ne pas serrer pour le moment).
- Placer les 2 boulons M6 restants dans le bloc de fixation (M0462) de façon à ce que les têtes des boulons se placent dans les contre alésages du bloc.
- Monter l'ensemble en position comme indiqué sur la photo en haut à droite, en veillant à ce que le peg soit dans une position confortable.
- Placer la plaque restante en position et serrer les 2 boulons M6.
- Tournez le peg de façon à ce que le trou pointe vers le bas puis serrer le boulon M8.
- Placer le slider dans le peg puis bloquer la position en utilisant la vis.
- L'ensemble peut être tourné ou enlevé lorsque vous n'en avez pas besoin.

ISSUE 1 22/02/2016 (NSY)

Notice disponible au téléchargement sur www.rg-racing.com

COUPLES DE SERRAGE RECOMMANDÉS

M4 BOULON = 8Nm
M5 BOULON = 12Nm
M6 BOULON = 15Nm
M8 BOULON = 20Nm
M10 BOULON = 40Nm

CONSUMER NOTICE

The catalogue description and any exhibition of samples are only broad indications of the Products and R&G may make design changes which do not diminish their performance or visual appeal and supplying them in such state shall conform to the order. The Buyer acknowledges no representation or warranty (other than as to title) has been given or will apply to the Products other than those in R&G's order or confirmation and the Buyer confirms it has chosen the Products as being of merchantable quality and suitable for its particular purposes. Where R&G fits the Products or undertakes other services it shall exercise reasonable skill and care and rectify any fault free of charge unless the workmanship has been disturbed. The Buyer is responsible for ensuring that the warranty on the motorcycle is not affected by the fitting of the Products. On return of any defective Products R&G shall at its option either supply a replacement or refund the purchase money but shall not be liable if the Products have been modified or used or maintained otherwise than in accordance with R&G's or manufacturer's instructions and good engineering practice or if the defect arises from accident or neglect. Other than identified above and subject to R&G not limiting its liability for causing death and personal injury, it shall not be liable for indirect or consequential loss and otherwise its liability shall be limited to the amounts paid by the Buyer for the Products or the fitting or service concerned. These terms do not affect the Buyer's statutory rights.

R&G RACING RETURNS POLICY (NON-FAULTY GOODS)

Returns must be pre-authorized (if not pre-authorized the return will be rejected). Goods may only be returned direct to us if they were purchased direct from us (customer must prove if necessary). Otherwise to be returned to original vendor. Goods must be in re-sellable condition, in the opinion of R&G Racing. All returns are subject to a 25% restocking and handling fee (25% of the gross value exc. P&P – at the prevailing price at time of purchase). The customer must pay any and all carriage charges. No returns of discontinued products, unless within 14 days of purchase. This policy does not affect your statutory rights and does not refer to faulty goods.

R&G Racing

Unit 1, Shelley's Lane, East Worldham, Alton, Hampshire, GU34 3AQ

Tel: +44 (0)1420 89007 Fax: +44 (0)1420 87301 www.rg-racing.com Email: info@rg-racing.com